

HORIZONTAL CROSS-SECTION / PLAN VIEW

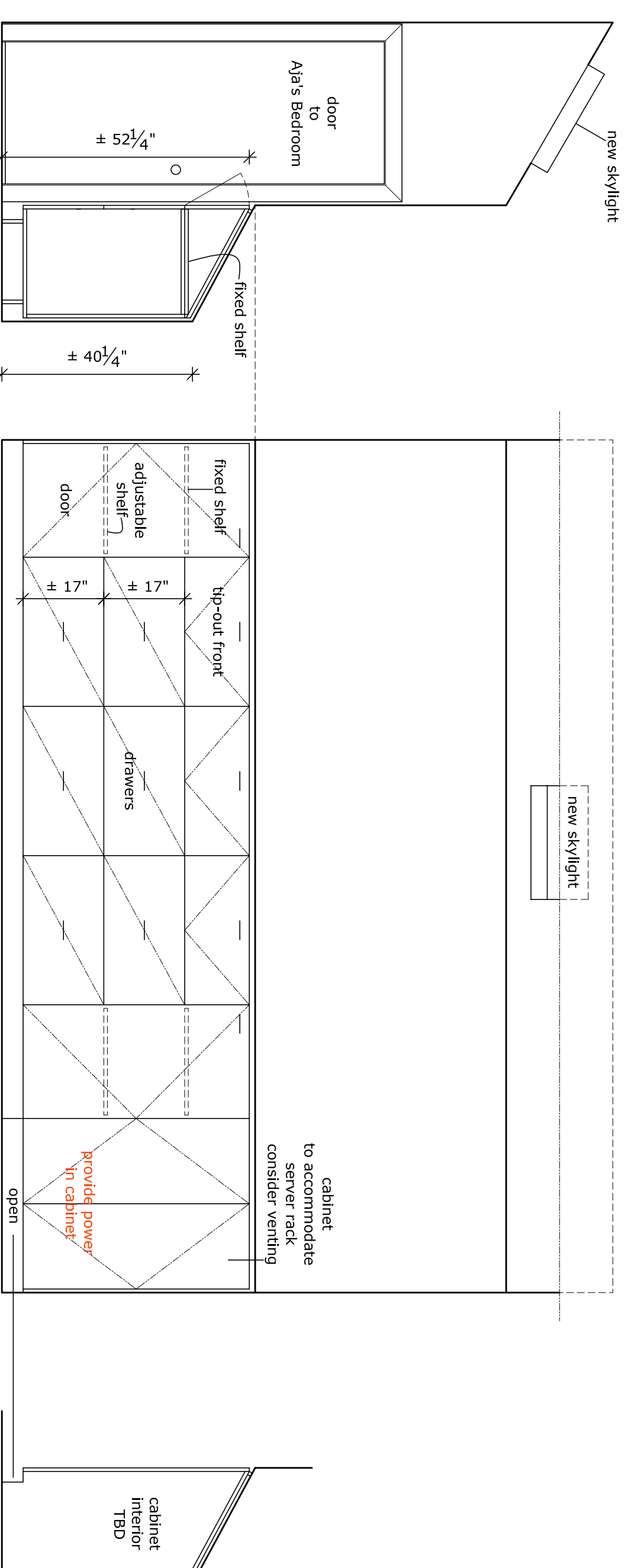

CROSS-SECTION over open shelves

FRONT ELEVATION

CROSS-SECTION over server rack cabinet

UPPER FLOOR - LANDING CABINETS

notes:
 1: Removal of walls is subject to review and approval by a VA State licensed structural engineer.
 2: It is the cabinet manufacturer's responsibility to ensure that space and clearance requirements for appliances, as well as space requirements for appliance door swings, are built according to manufacturer's specifications.
 3: If the cabinet manufacturer, or any other trade, detects structural or drywall deficiencies that affect styling, please notify client, builder and/or Tom Bakker Design promptly to discuss solution.
 4: All dimensions indicated on this drawing are to FINISHED surfaces.

drawing title: Upper Floor - Landing cabinetry
 scale: 1/2"=1'-0"
 sheet size: 24" x 36"
 date: August 6, 2020
 revision date: November 16, 2020

TOM BAKKER
 design
 www.tombakkerdesign.com 206.877.3327

client: Ray and Karl Ramadorai
 project: Private Residence - Sammamish, WA home remodel
 project no: 2007

07
 drawing number